

Attachments

Merlo applies a simple and effective principle when developing its products.

From the design to the build: everything is conceived, designed and built in the Merlo Group Research Centre. This simple principle also applies to our attachments.

Armed with years of experience, Merlo's engineers have developed a wide range of attachments of various types and load capacities.

This work method ensures a broad range of tested and interchangeable attachments that help save time and effort.

BALE FORKS



MANURE FORKS WITH CLAW

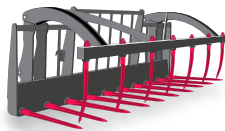

PINCERS FOR ROUND BALES



MULTI-PURPOSE LOADER WITH CLAW

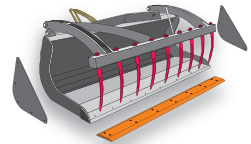

LOADERS

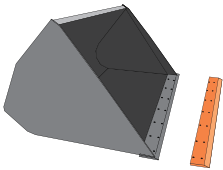

HOOKS/LIFTING BOOMS



PINCERS FOR ROUND WRAPPED BALES

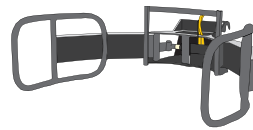

PLATFORMS





Merlo in figures

- **1200 employees**
- **Overall surface area of 300,000 m² of which 220,000 m² is covered**
- **Approximately 90% of turnover from export**
- **More than 50 markets across the world**
- **6 branches and more than 600 dealers**
- **8% of turnover invested in R & D**
- **60 production robots**
- **90% of production in-house**

The Merlo brand has always been a leader in advanced technology in the telehandler field. Since 1964, we have brought experience, determination and passion to everything we do.

Developing complex products, from the idea to the result, from design to sales, means being able to anticipate trends in the most competitive markets.

Merlo Group's dedication has resulted in the design and manufacture of compact, easy-to-handle telehandlers which offer market-leading performance, comfort, efficiency and safety.





Multifarmer

MF34.7 - MF34.9
MF40.7 - MF40.9

The data, features and illustrations contained in this document are for indicative purposes only, and are not binding. Merlo Spa pursues a policy of continual research and development, and as such, our products may feature characteristics that differ from those described or may be subject to modification without prior notice. The products illustrated may include optional equipment.



MERLO S.P.A.

Via Nazionale, 9 - 12010 S. Defendente di Cervasca - Cuneo - Italia

Tel. +39 0171 614111 - Fax +39 0171 684101

www.merlo.com - info@merlo.com